

## Tuleja do prowadzeń kulkowych- TKP Bush for ball bearing guides - TKP

Material/Material: 1.3505  
 Twardość/Hardness: 62±2 HRC  
 Norma/Standard: ISO 9448-3

Max. szybkość pracy/Max. speed: 150 m/min

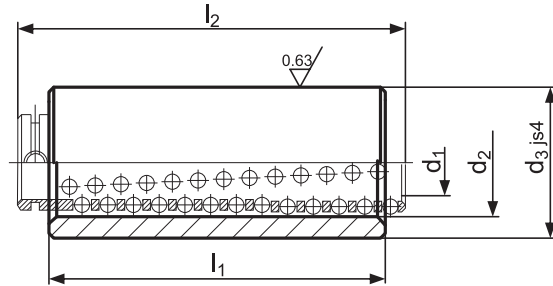

Montaż na klej LOCTITE 648  
 Mounted on LOCTITE 648 adhesive

Rekomendowana dokładność gniazda - d<sub>3</sub> (H5)  
 Recommended precision of the socket - d<sub>3</sub> (H5)

l <sub>1</sub>	l <sub>2</sub>	d <sub>3</sub>	d <sub>2</sub>	d <sub>1</sub>	Nr katalogowy Item no.	d <sub>2</sub>	d <sub>1</sub>	Nr katalogowy Item no.
23	45	32	26	20	TKP-20023	25	19	TKP-19023
30	45				TKP-20030			TKP-19030
37	45				TKP-20037			TKP-19037
47	56				TKP-20047			TKP-19047
60	71				TKP-20060			TKP-19060
77	95				TKP-20077			TKP-19077
23	45	40	31	25	TKP-25023	30	24	TKP-24023
30	45				TKP-25030			TKP-24030
37	45				TKP-25037			TKP-24037
47	56				TKP-25047			TKP-24047
60	71				TKP-25060			TKP-24060
77	95				TKP-25077			TKP-24077
30	45	48	40	32	TKP-32030	38	30	TKP-30030
37	50				TKP-32037			TKP-30037
47	56				TKP-32047			TKP-30047
60	71				TKP-32060			TKP-30060
77	95				TKP-32077			TKP-30077
95	120				TKP-32085			TKP-30085
30	45	58	48	40	TKP-40030	46	38	TKP-38030
37	50				TKP-40037			TKP-38037
47	63				TKP-40047			TKP-38047
60	80				TKP-40060			TKP-38060
77	95				TKP-40077			TKP-38077
95	120				TKP-40095			TKP-38095
120	140	TKP-40120	TKP-38120					
37	50	70	58	50	TKP-50037	56	48	TKP-48037
47	63				TKP-50047			TKP-48047
60	80				TKP-50060			TKP-48060
77	95				TKP-50077			TKP-48077
95	120				TKP-50095			TKP-48095
120	140				TKP-50120			TKP-48120
60	95	85	71	63	TKP-63060	68	60	TKP-60060
77	95				TKP-63077			TKP-60077
95	120				TKP-63095			TKP-60095
120	140				TKP-63120			TKP-60120
120	140	105	92	80	TKP-80120	-	-	-